

S(1:2,5)

Бобышка поз.31 и часть корпуса до вставки и окончательного сверления бобышки T3
Boss pos.31 and part of shell prior to insertion and final drilling of boss T3

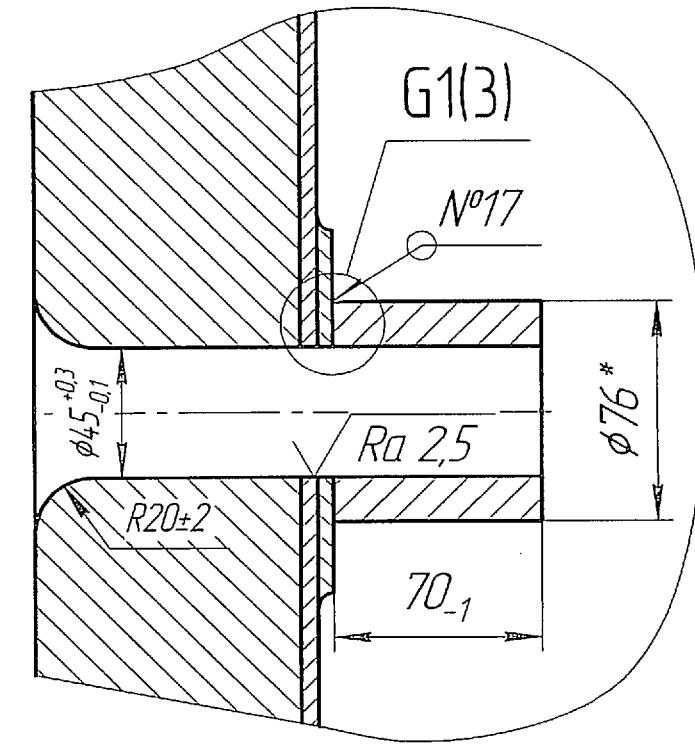

E(1:10)

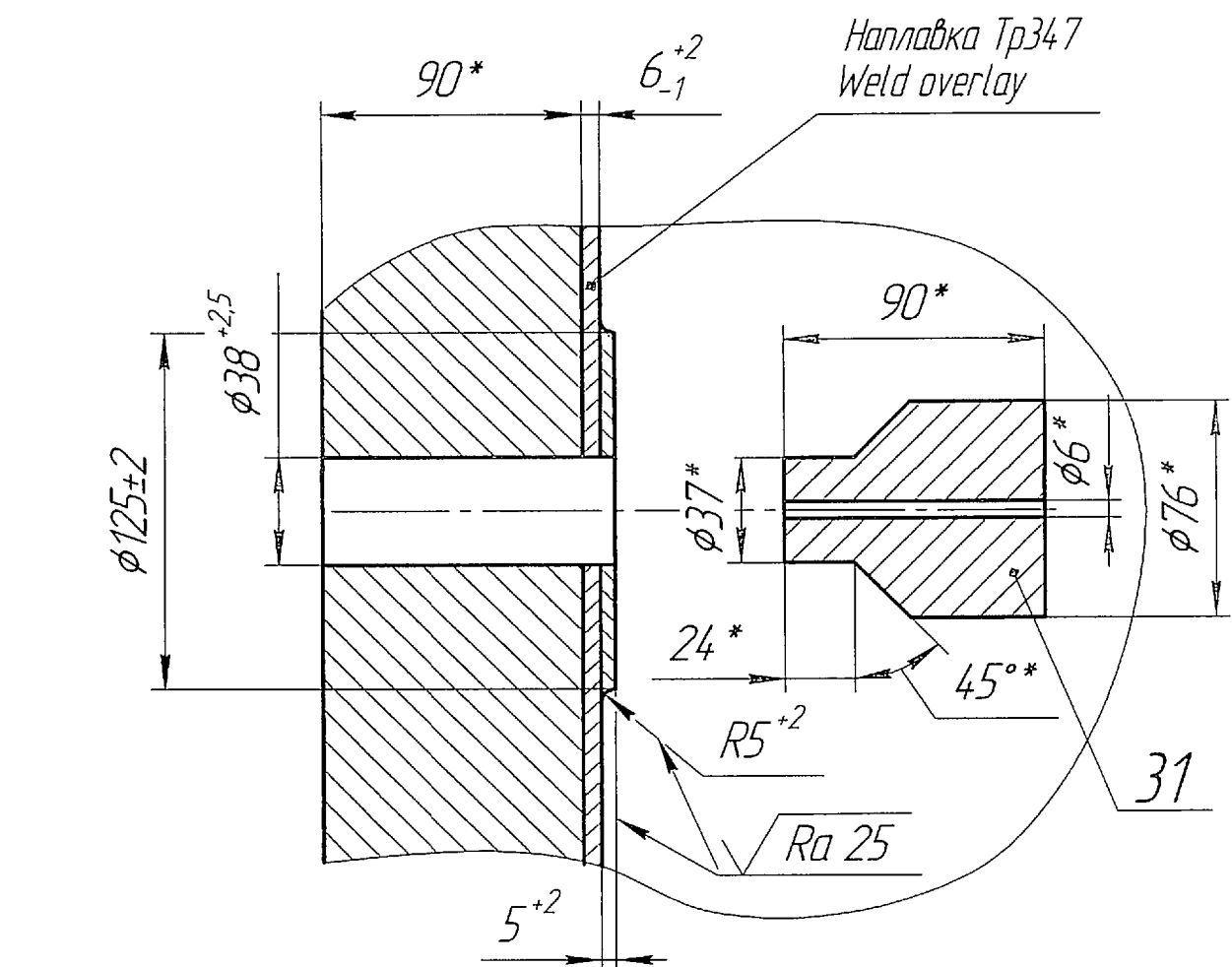
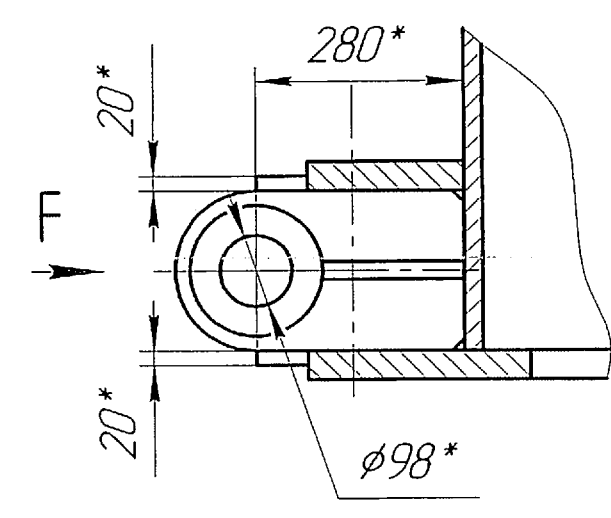

T(1:10)

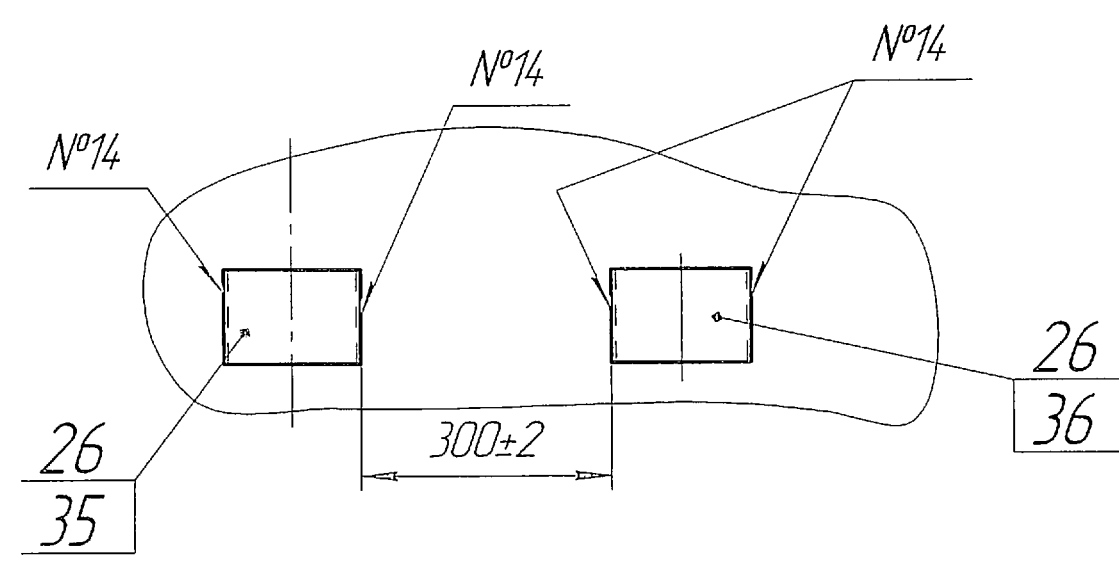

M(1:2)

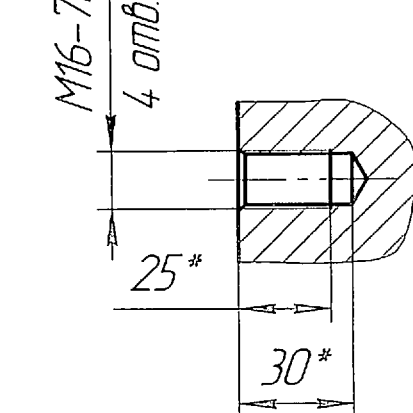

R(1:2)(1)

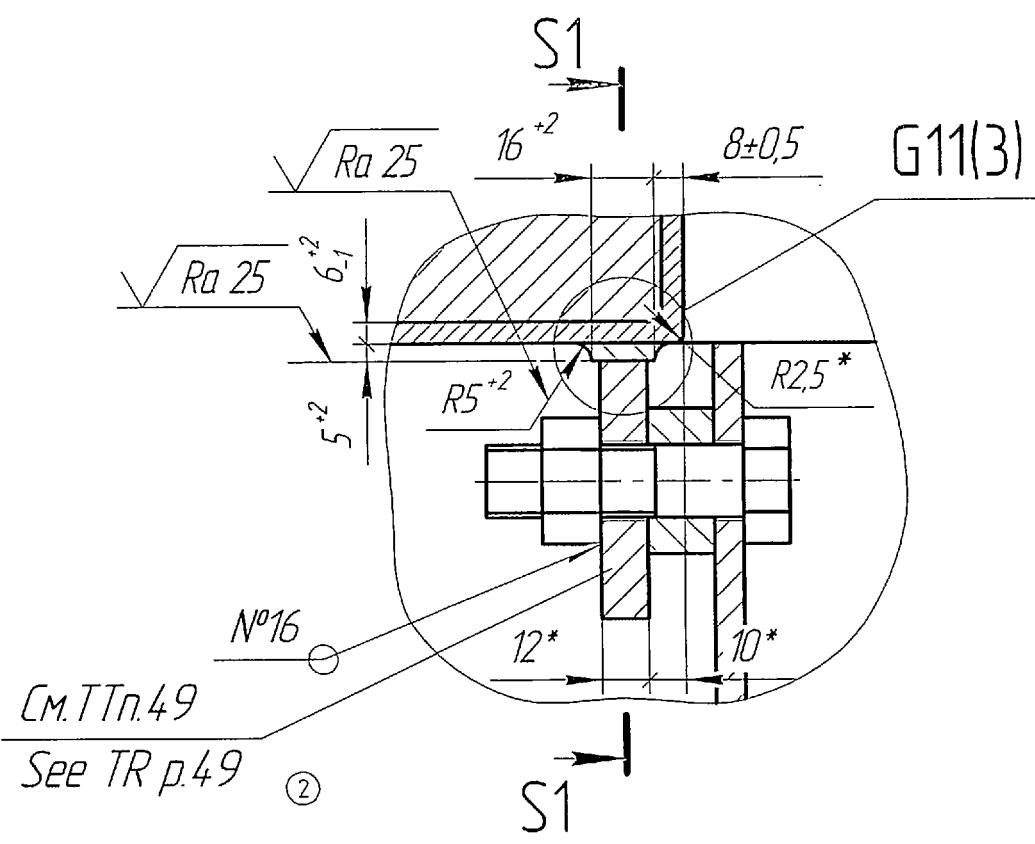

S1-S1(1:2)

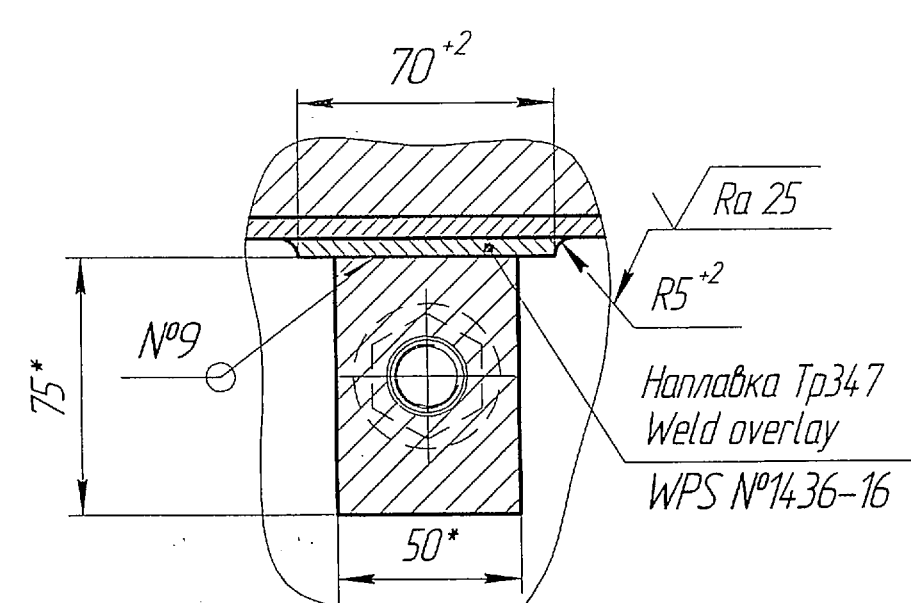

H(1:10)(1)

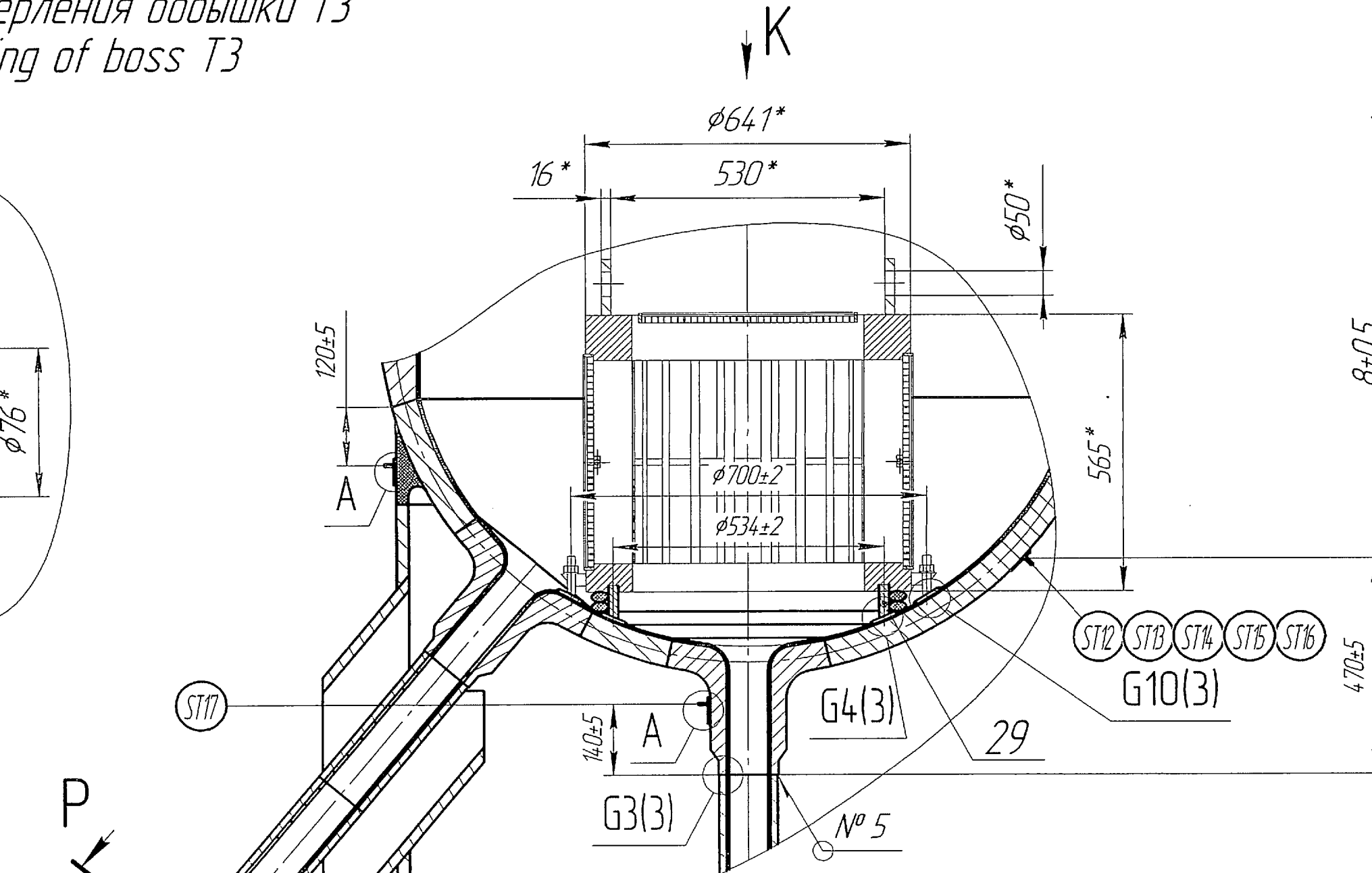

T-T(1:5)

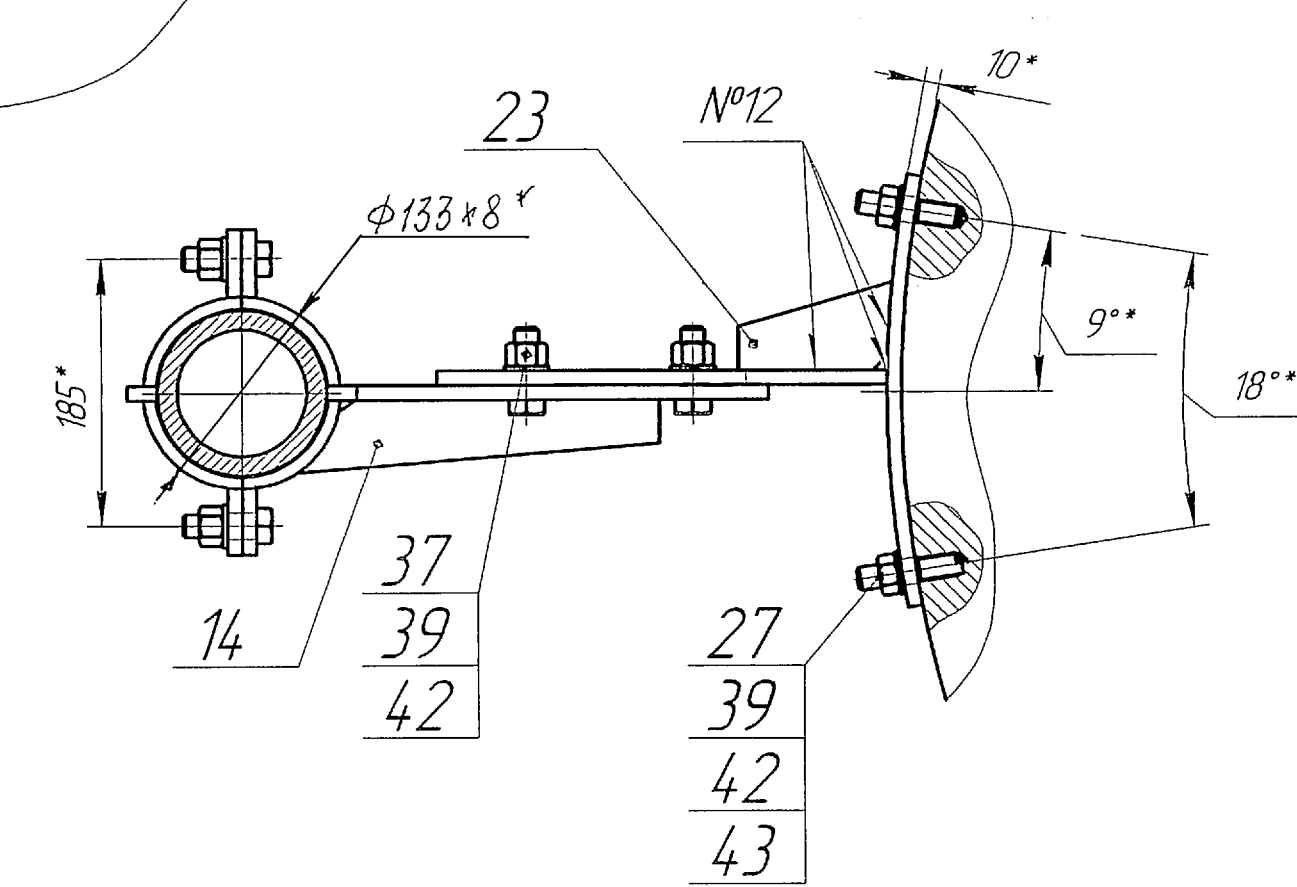

F(1:10)

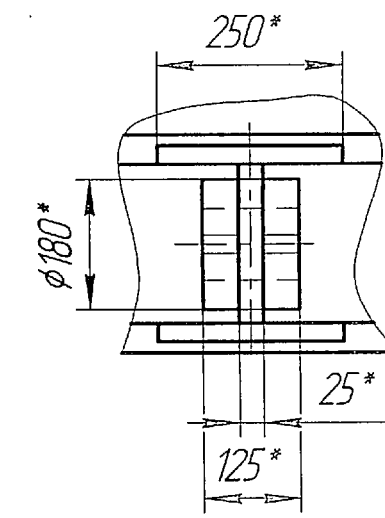

P1(1:2,5)

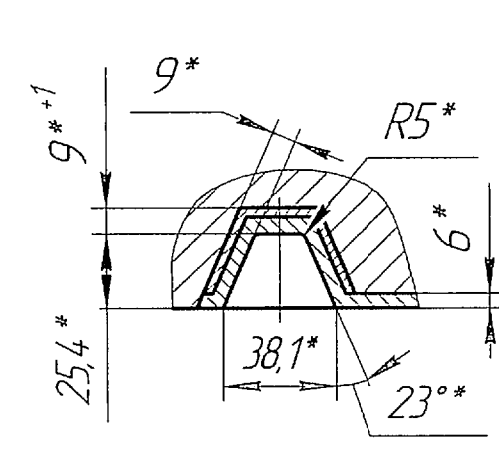

Y(1:5)

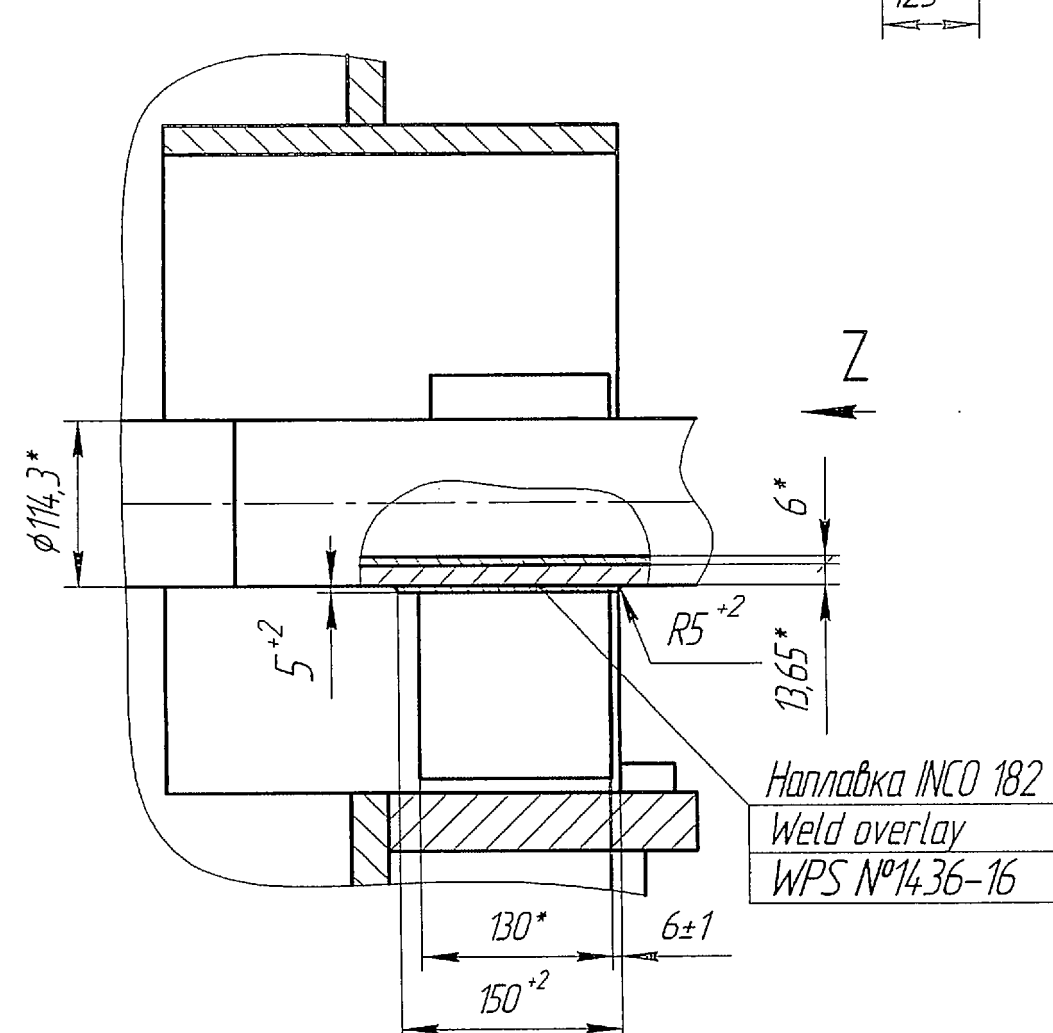

P-P(1:2)(1)O

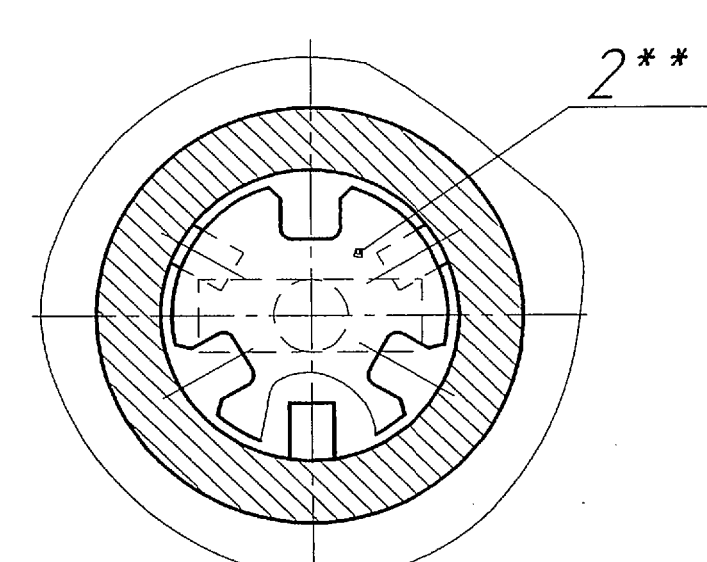

U-U(1:20)

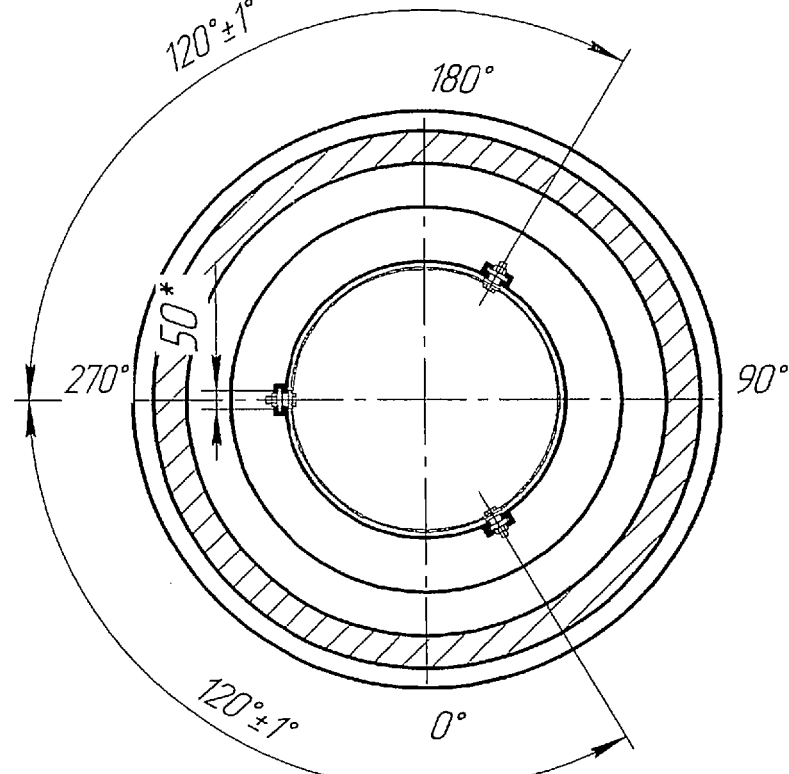

Q(1:5)O

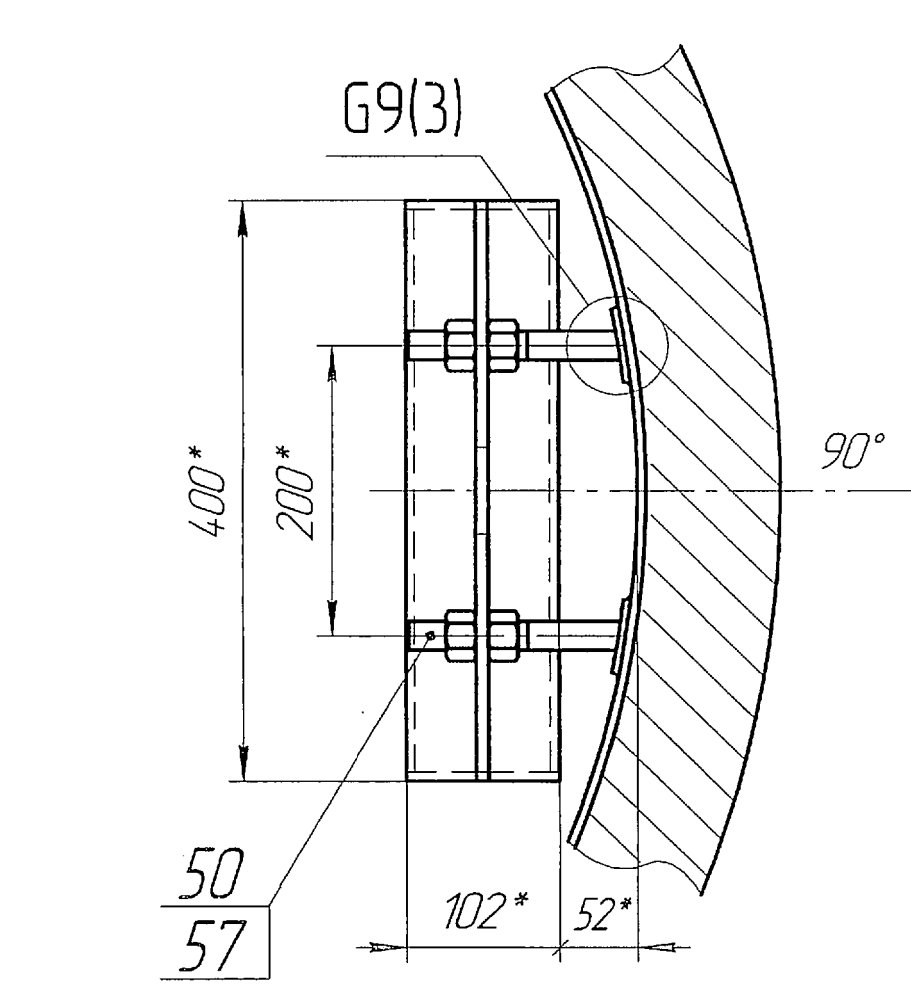

K(1:5)

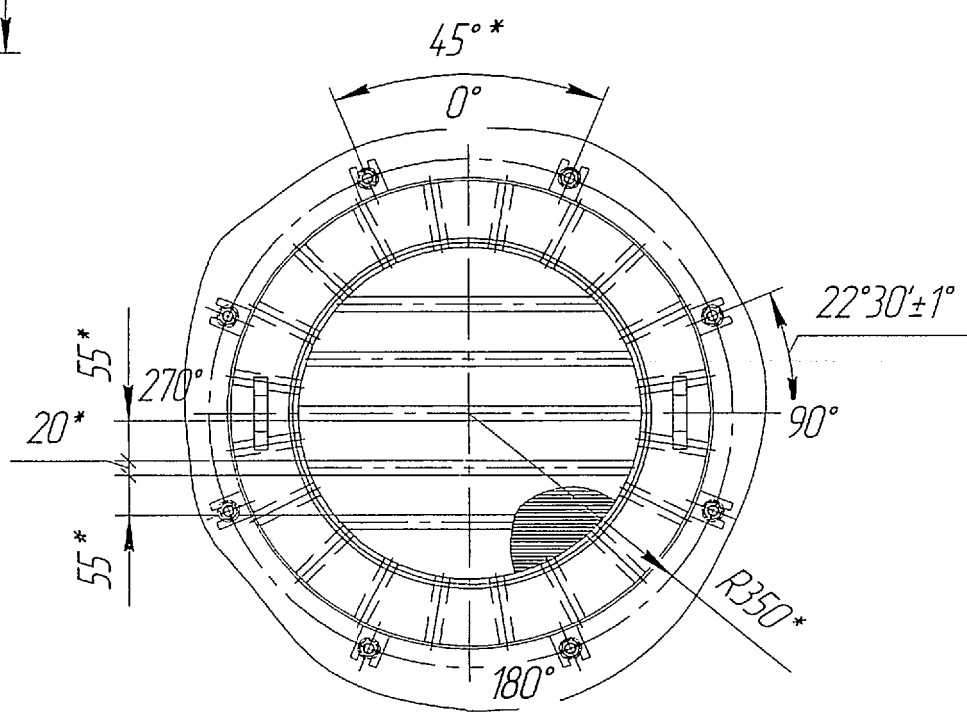

L(1:10)

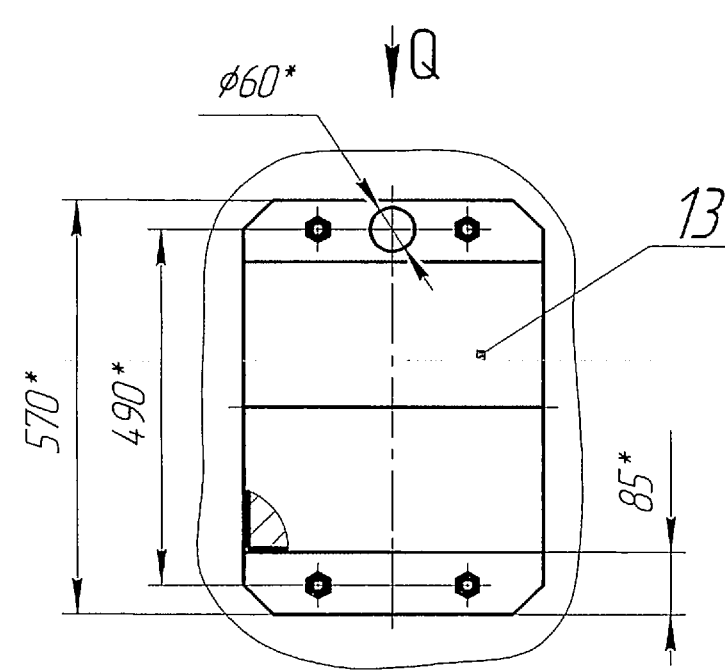

C(1:10)

Установка заглушек для гидротестирования на трубопроводы поз.9,10
Installation of blinds to pipelines for hydrotest (1:10)

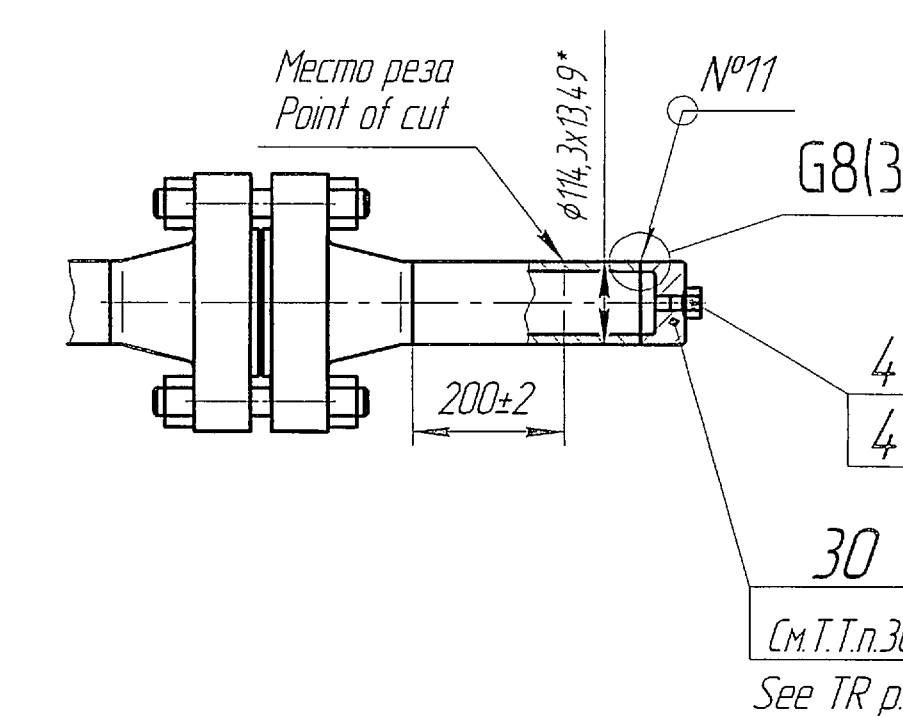

Установка заглушки для гидротестирования на бобышку поз.31
Installation of blind to boss pos.31 For hydrotest (1:5)

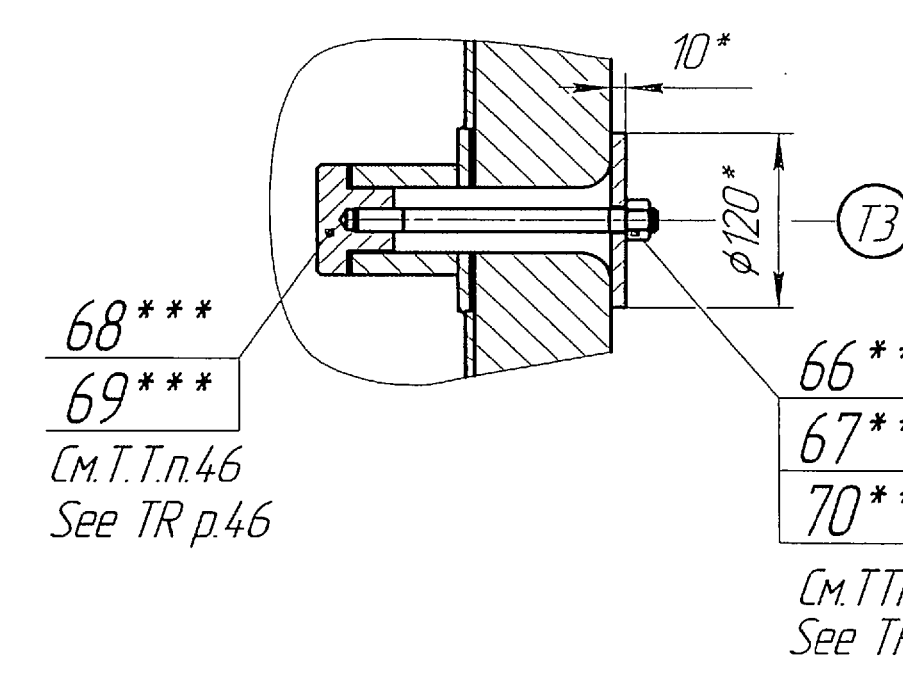

План истинного расположения термодпар
Plan of thermocouples actual location

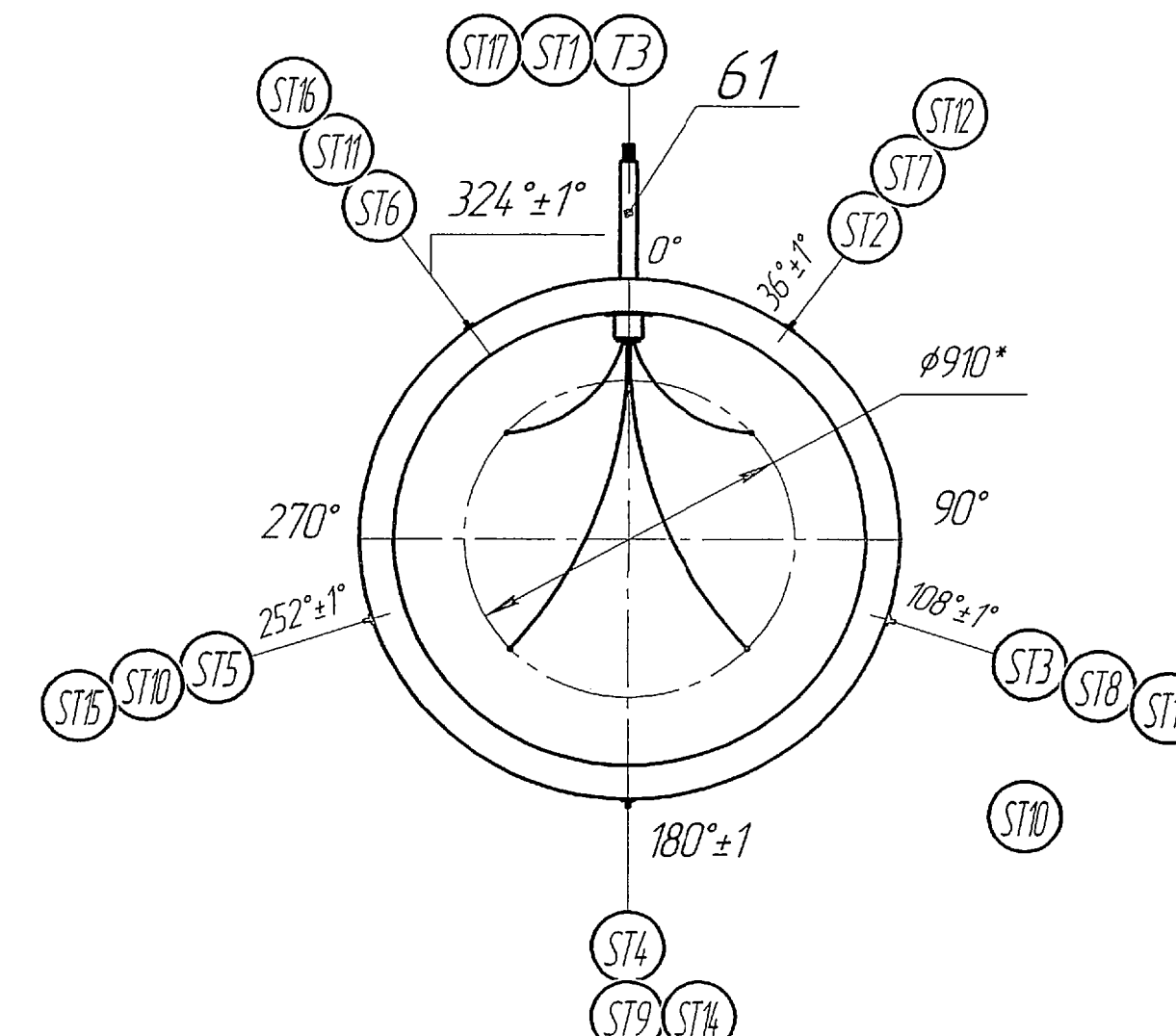

Крышка монтажная (1:15)
Lifting Cover



Схема строповки при транспортировке
Layout of slinging during transportation



Схема строповки на монтаже
Layout of slinging at field site

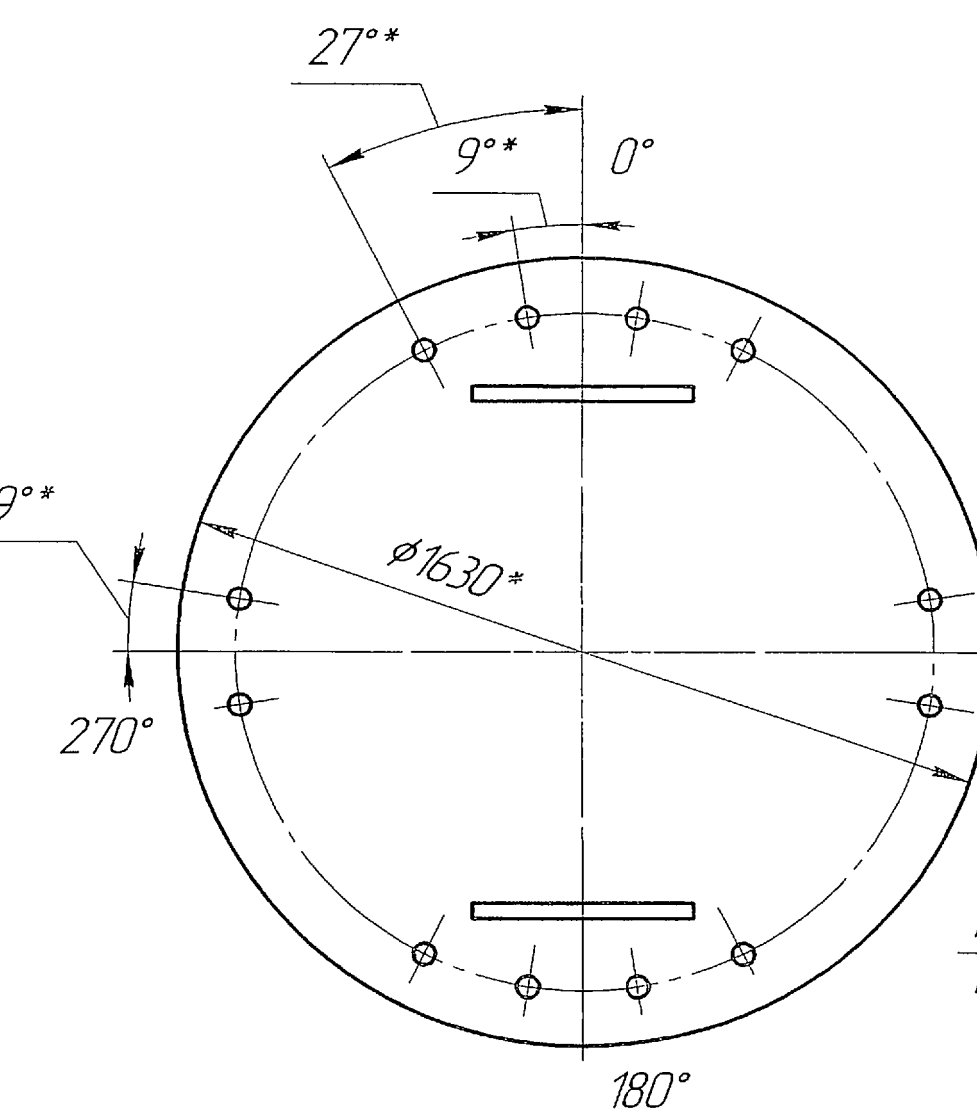
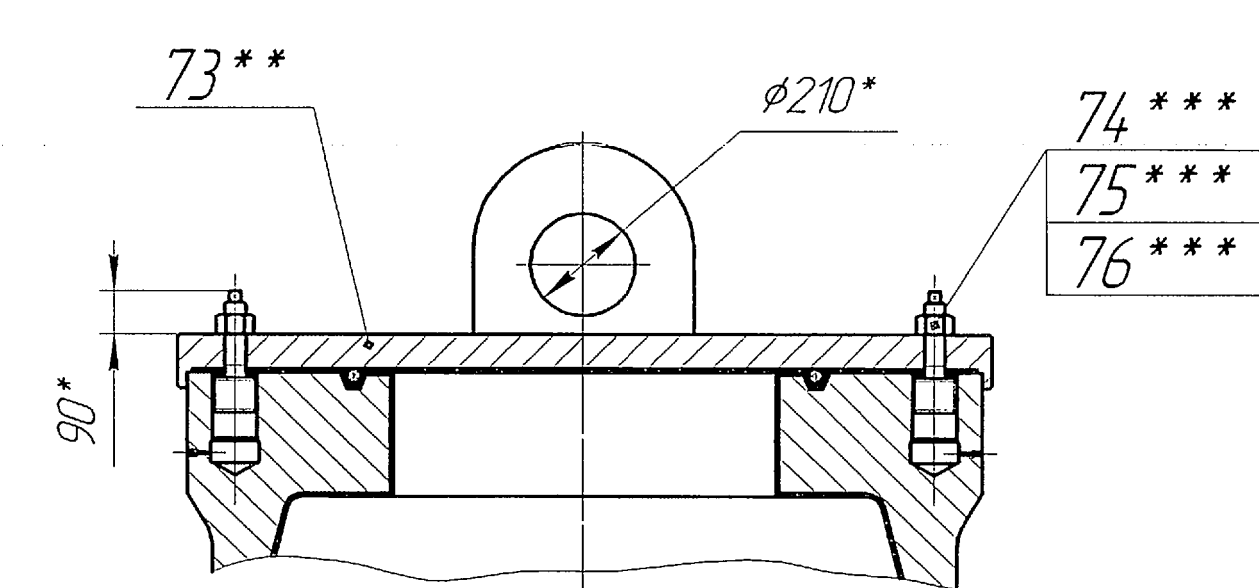

Шаблон опоры поз.72
Template Support

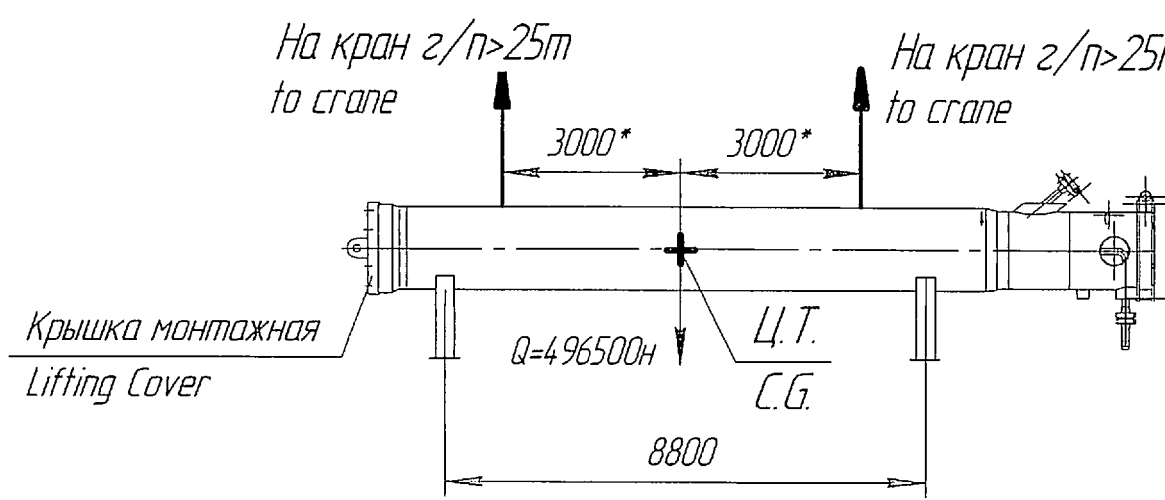
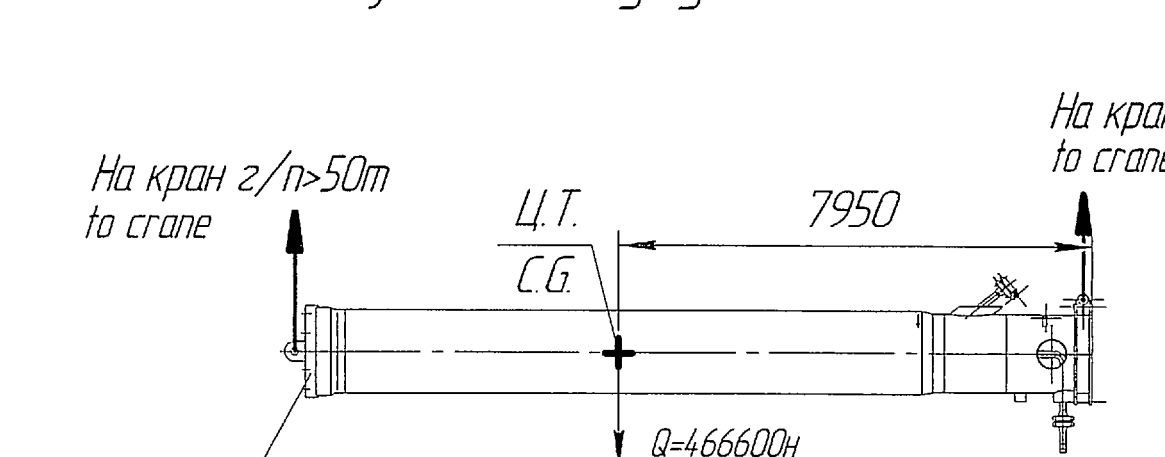
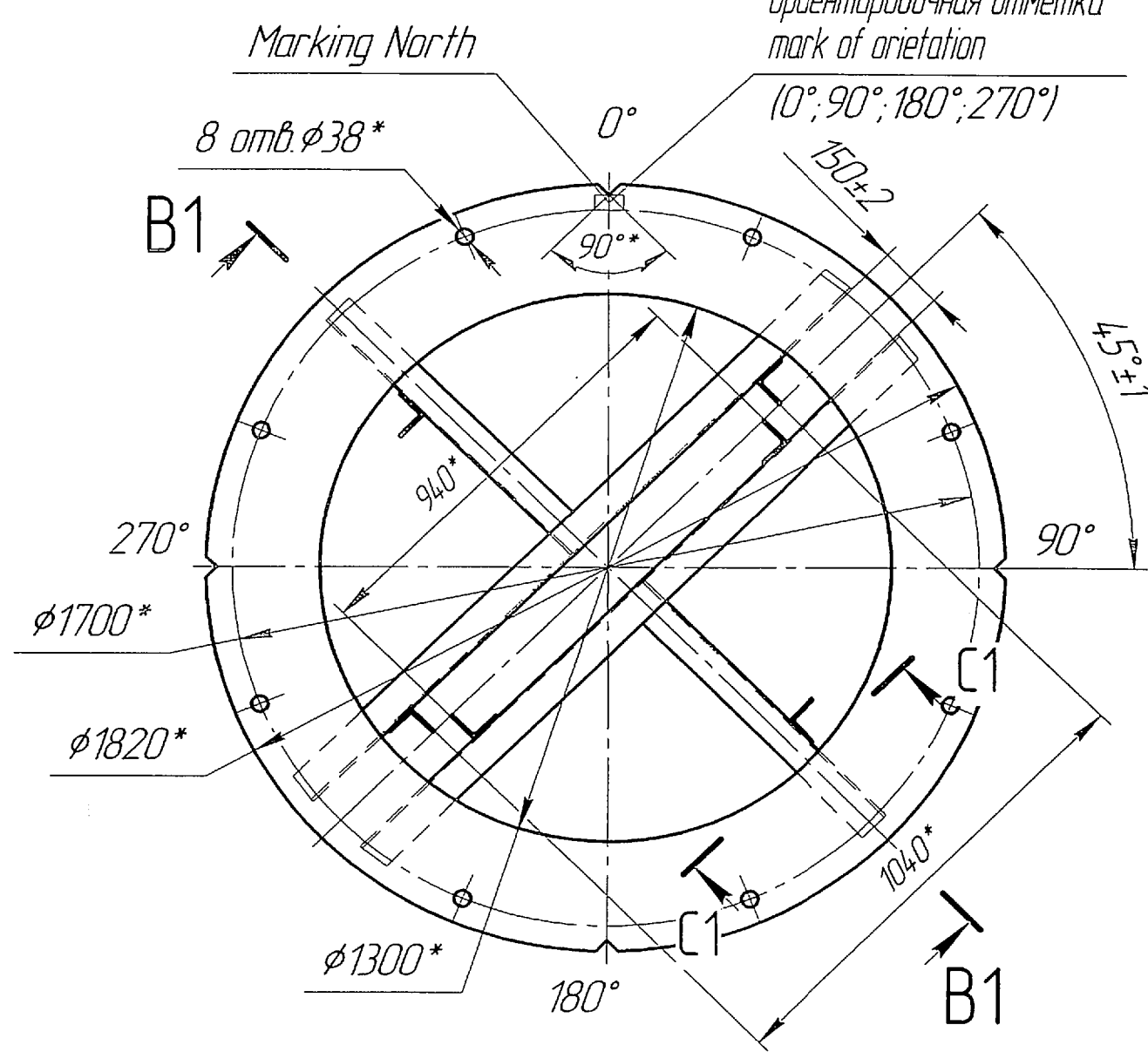

C1-C1(1:15)

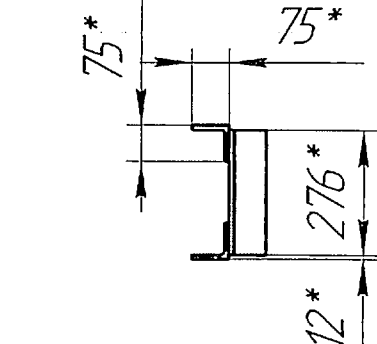

B1-B1O(1:15)



Схема строповки при транспортировке
Layout of slinging during transportation



Схема строповки на монтаже
Layout of slinging at field site

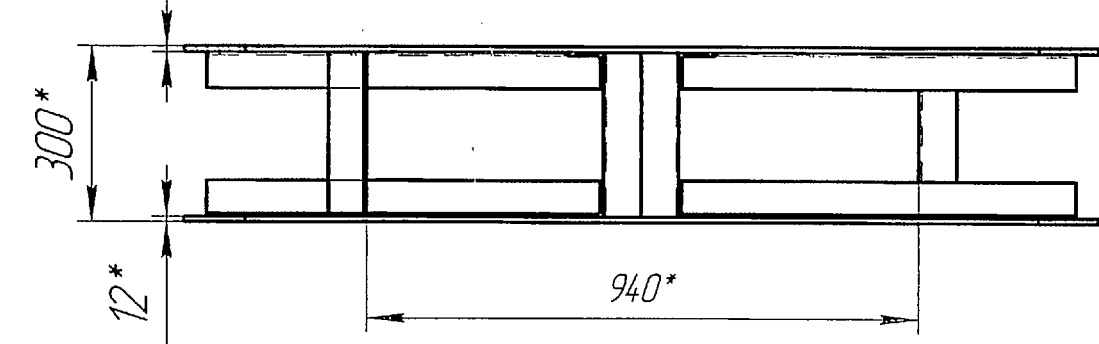

2	24824	24654	24654	24654	24654
1	Зам.	Зам.	Зам.	Зам.	Зам.
Rev	Sheet	Docum	Docum	Docum	Docum
Изм.	Изм.	Изм.	Изм.	Изм.	Изм.

G1 (1:1)(2)

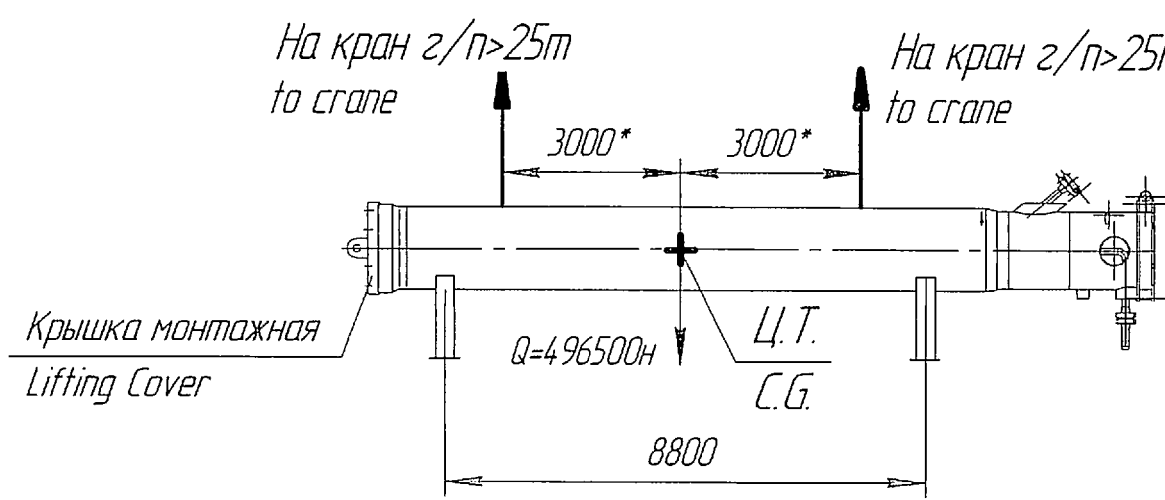
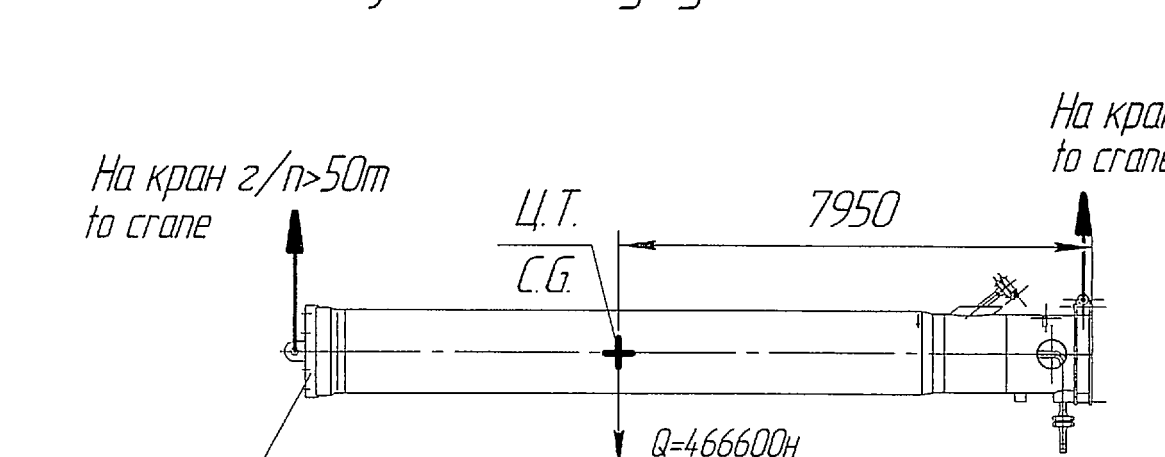
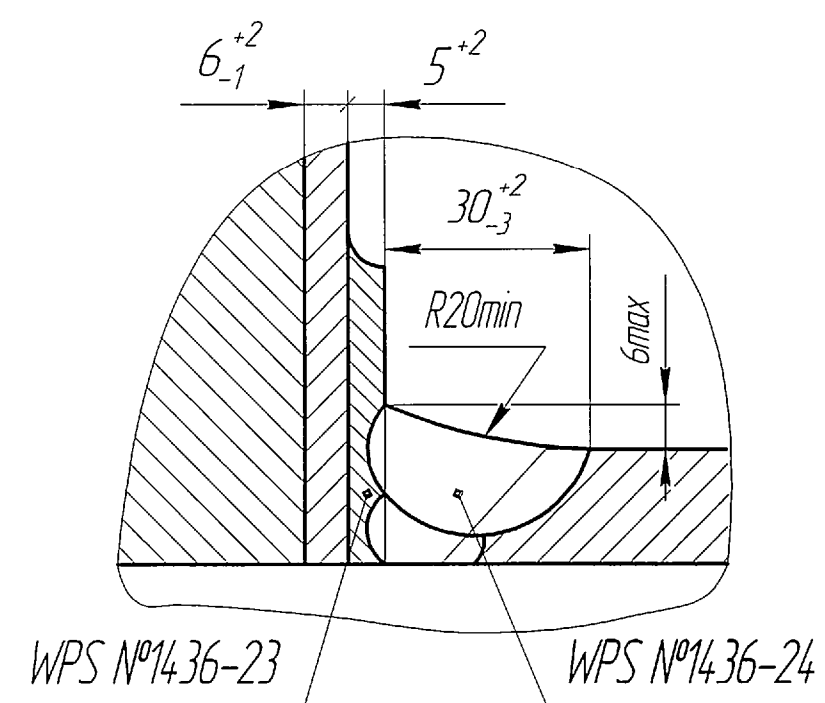

G8(1:1)

Приварка штуцеров N1, N4 поз.9,10
к заглушке поз.30
Welding nozzles N1, N4 pos. 9,10 to blind pos.30

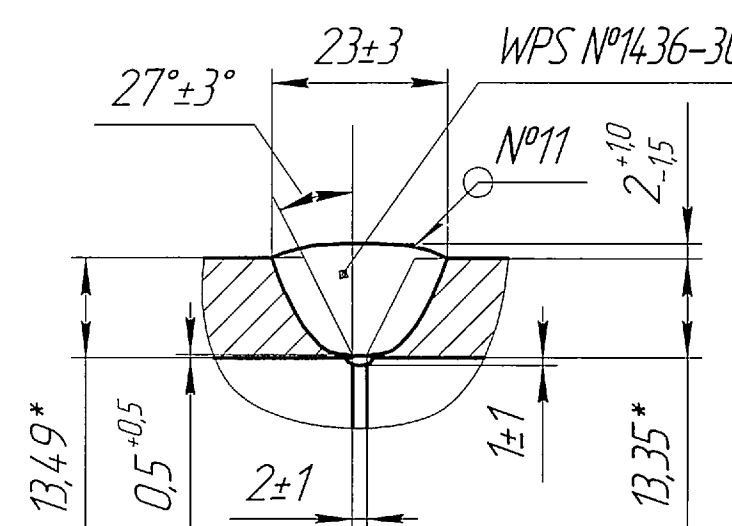

G10(1:2)

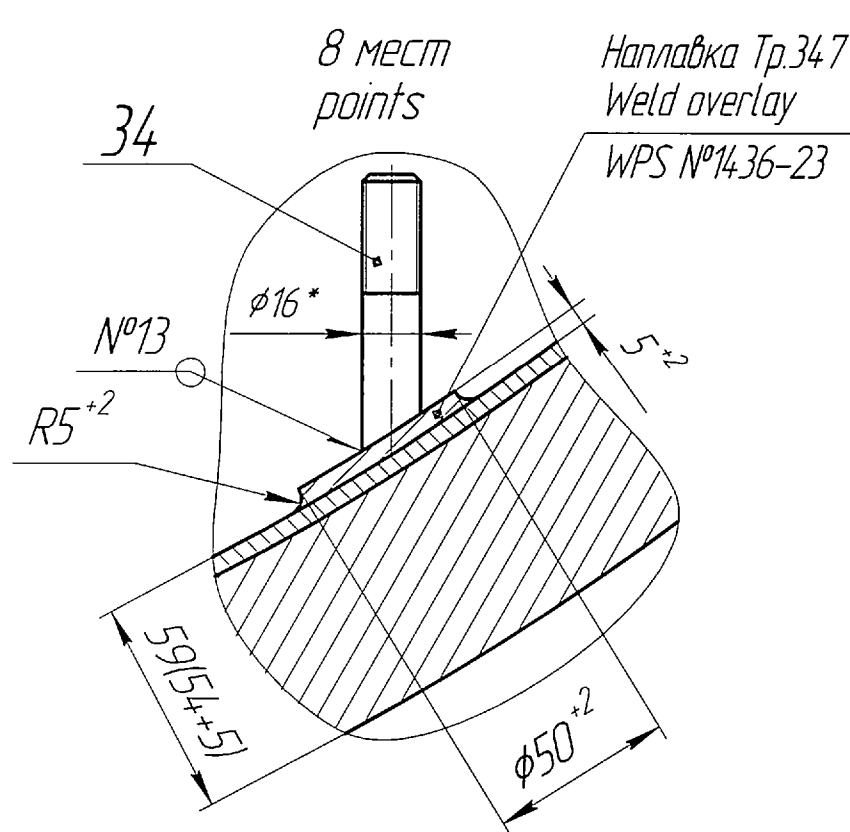

C(1:2)

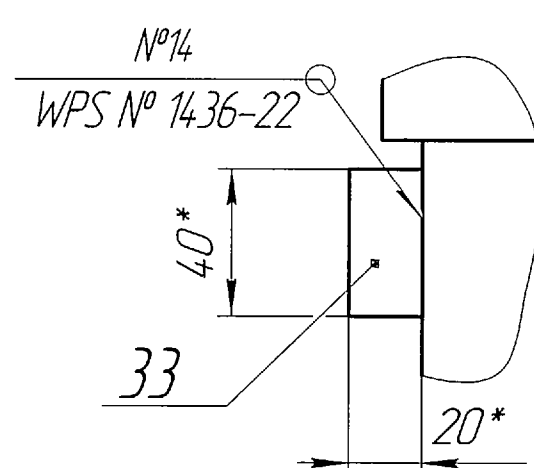

G12(1:1)

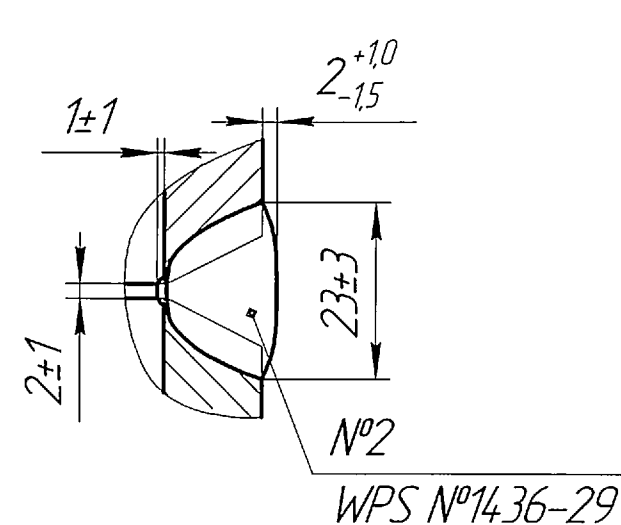

G2(1:1)

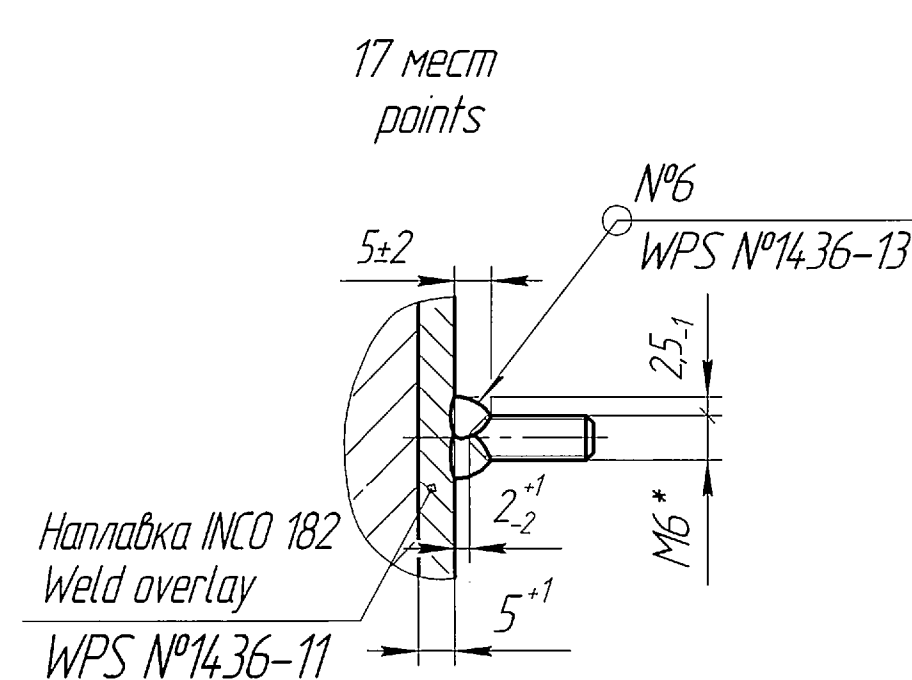

G9(1:2)

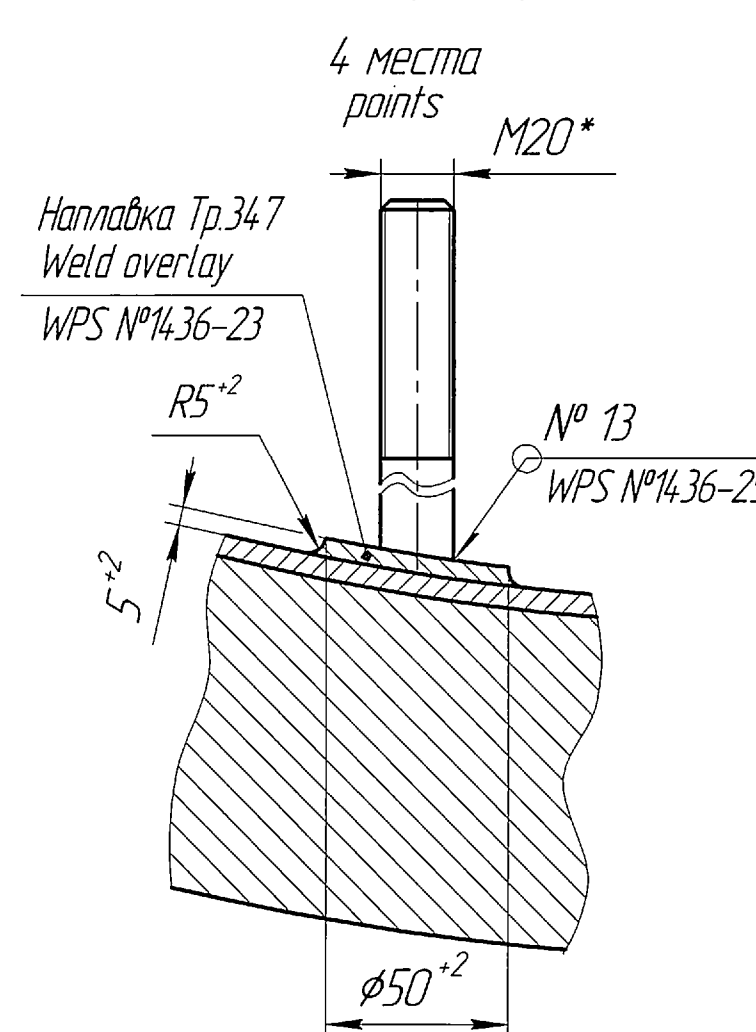

G7(1:1)

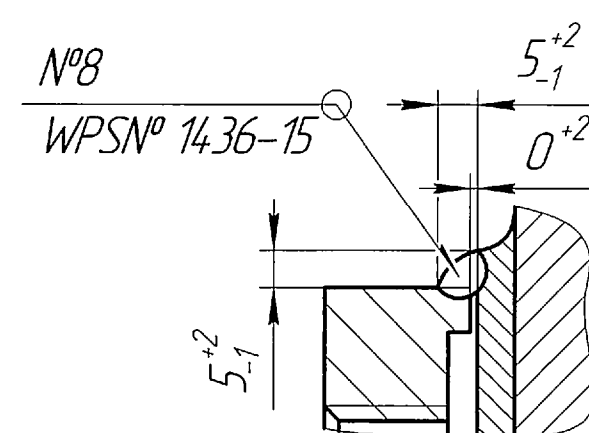

G5(1:2)

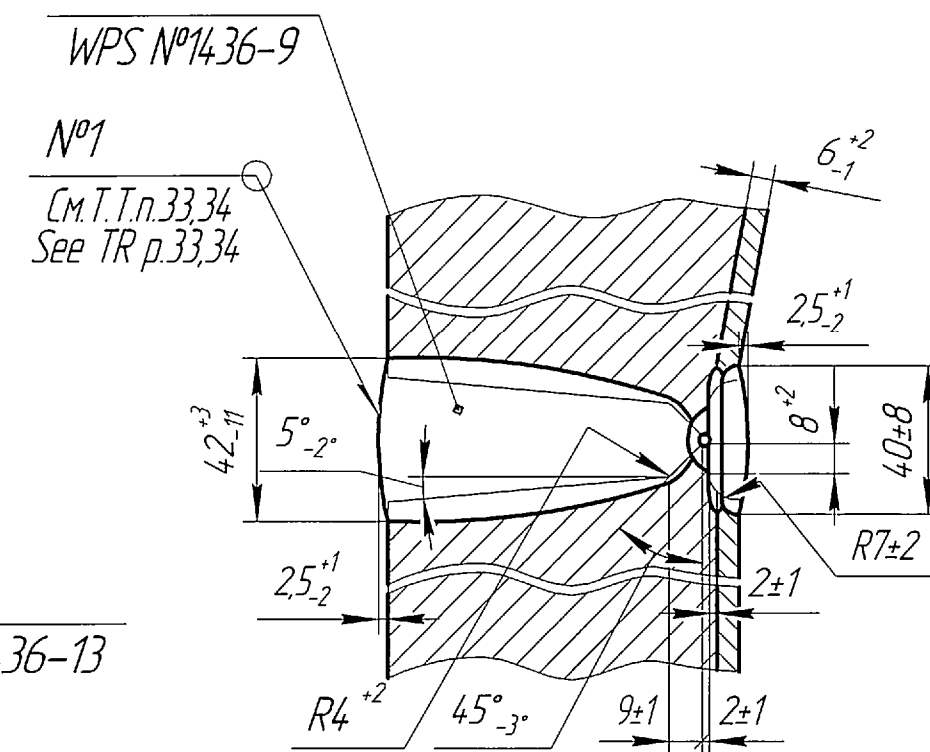

G6(1:1)

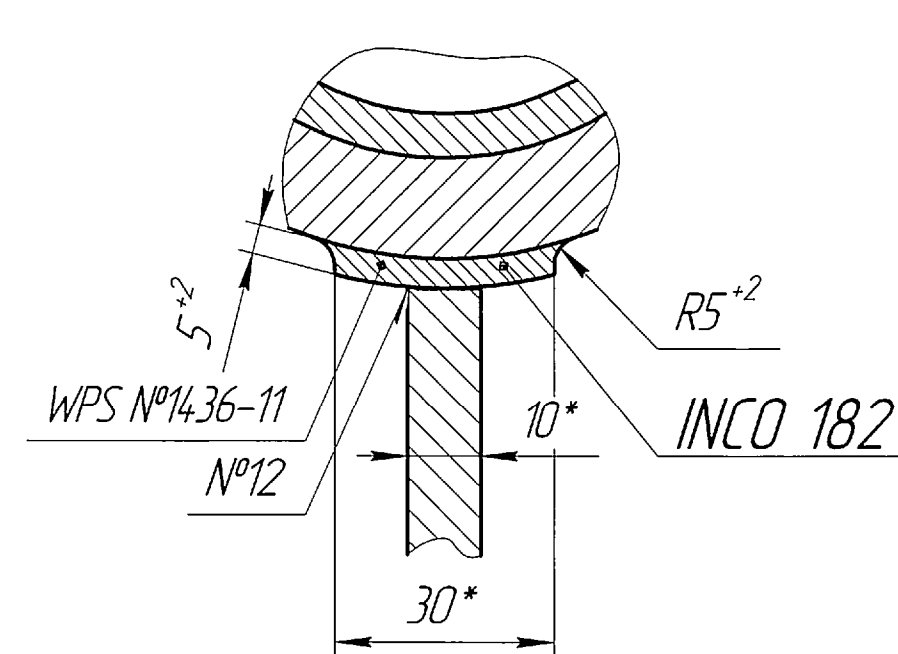

Hanлабка под приварку устройств
для выверки поз.44
Weld overlay for welding of
alignment devices pos.44
(1:2)

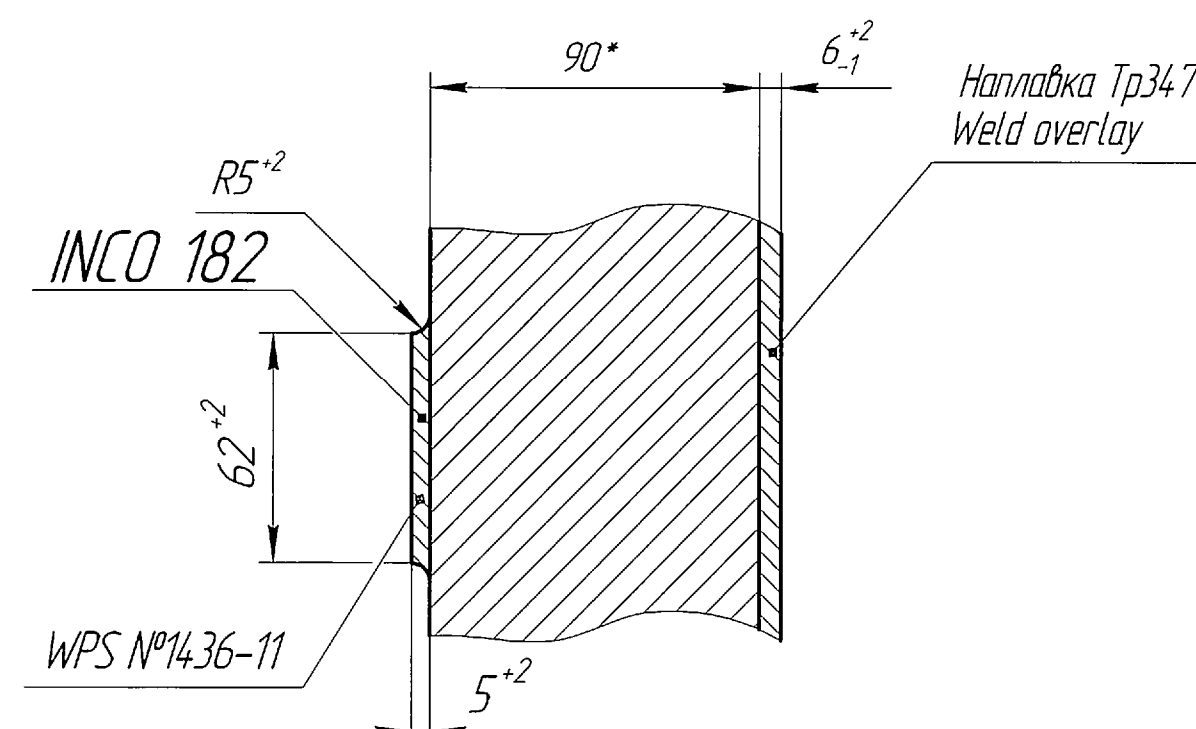

Hanлабка на днище под опорное кольцо поз.29 (1:2)
Weld overlay on head for support ring pos.29

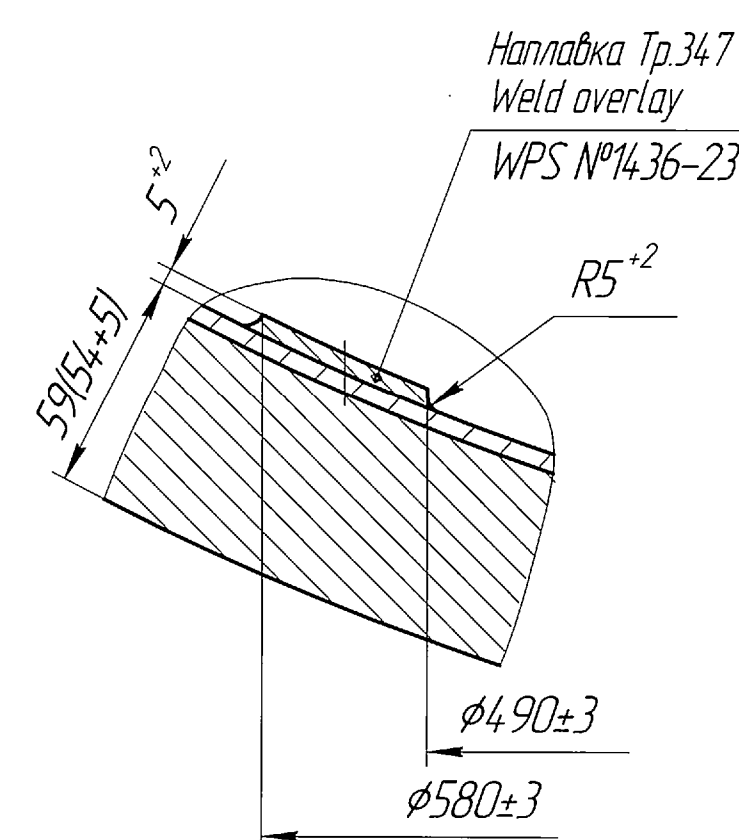

W-W (1:2)(1)

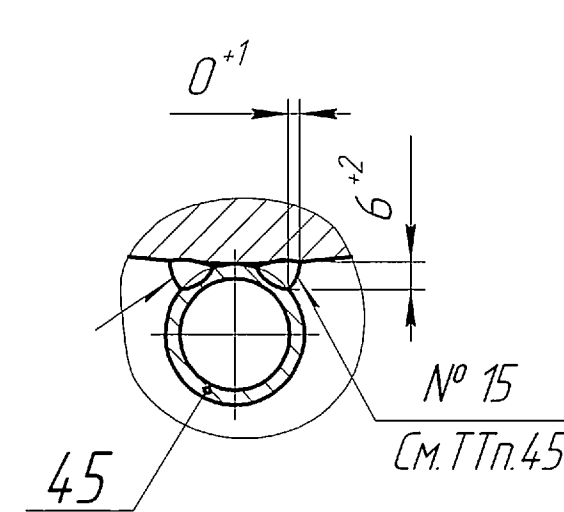

G3(2:1)

Приварка трубы к патрубкам штуцеров N1, N2
Welding of pipe to nozzle N1, N2

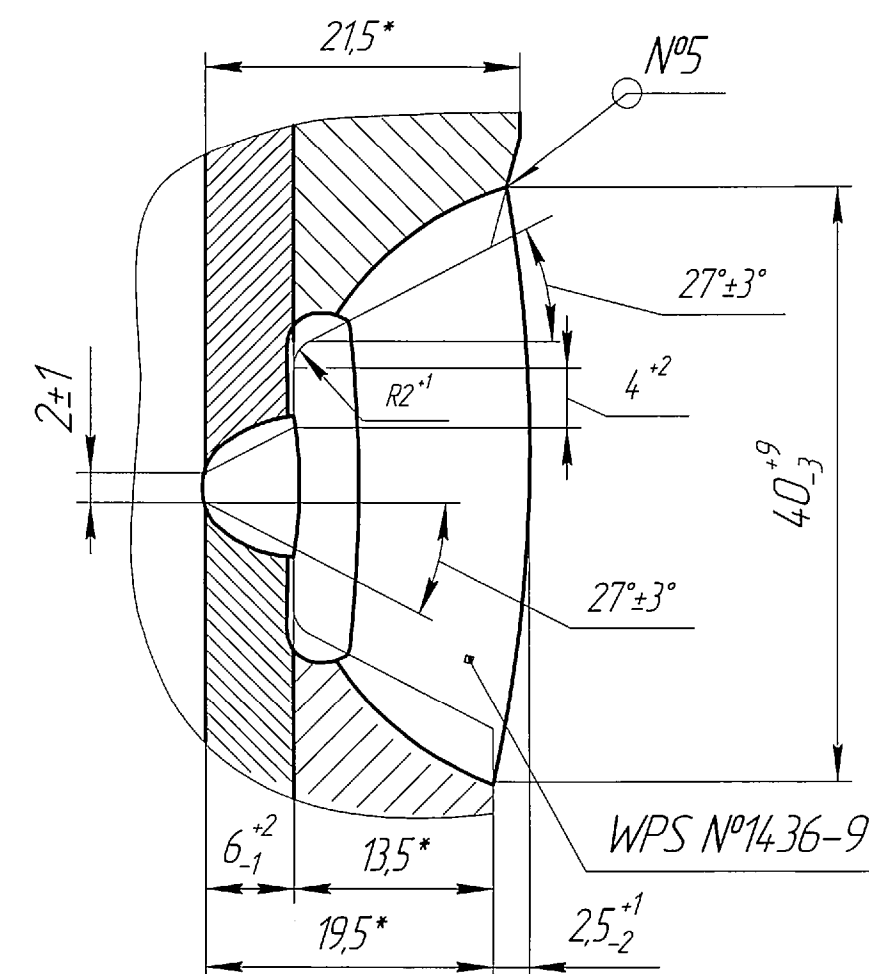

Hanлабка под опорное кольцо к корпусу
Weld overlay to shell for support ring
(1:2)

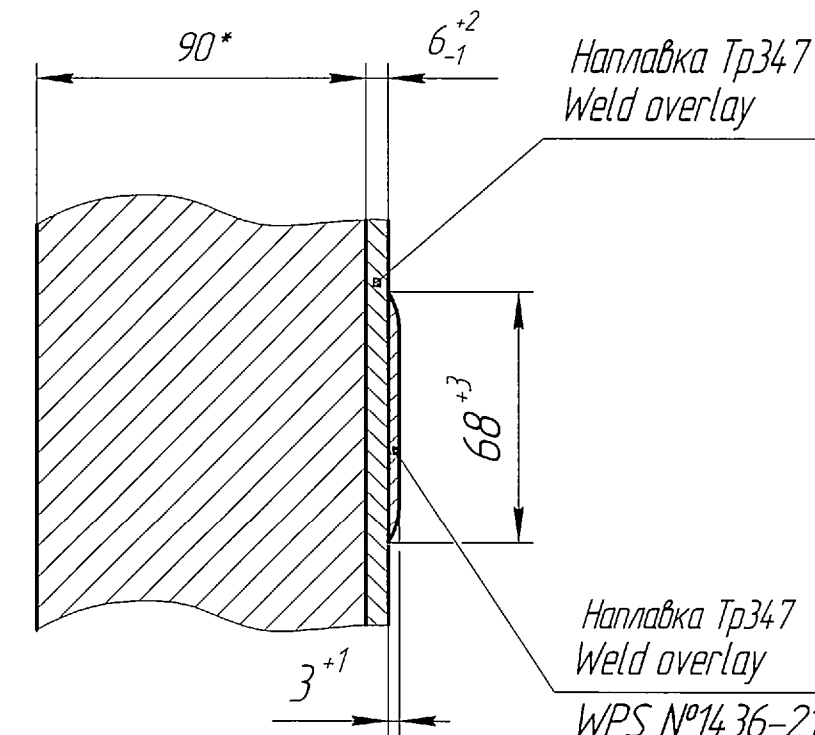

G4(1:2)

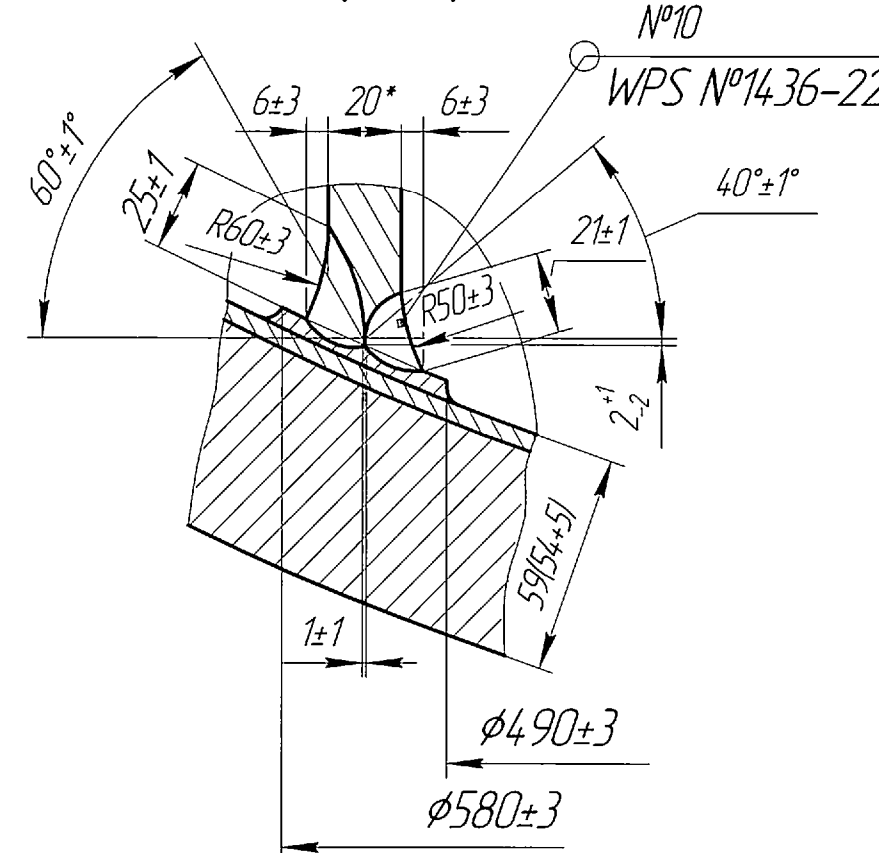

G11(1:2)

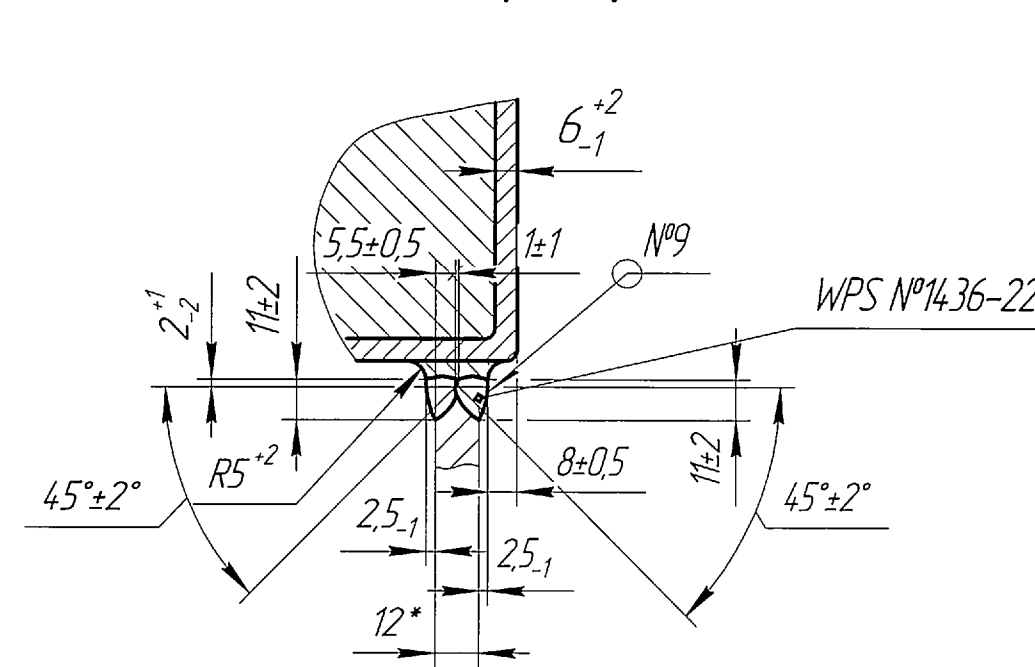

Hanлабка к корпусному фланцу поз.8
под приварную планку
Weld overlay to body flange welded strap

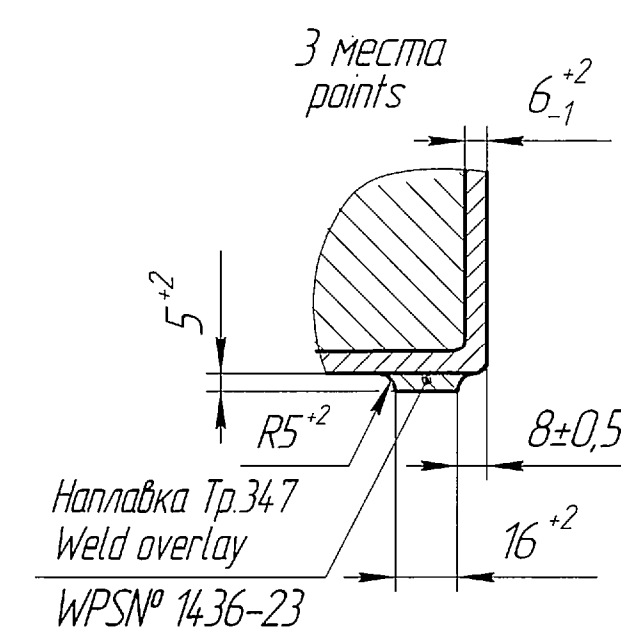

Y1(1:1)

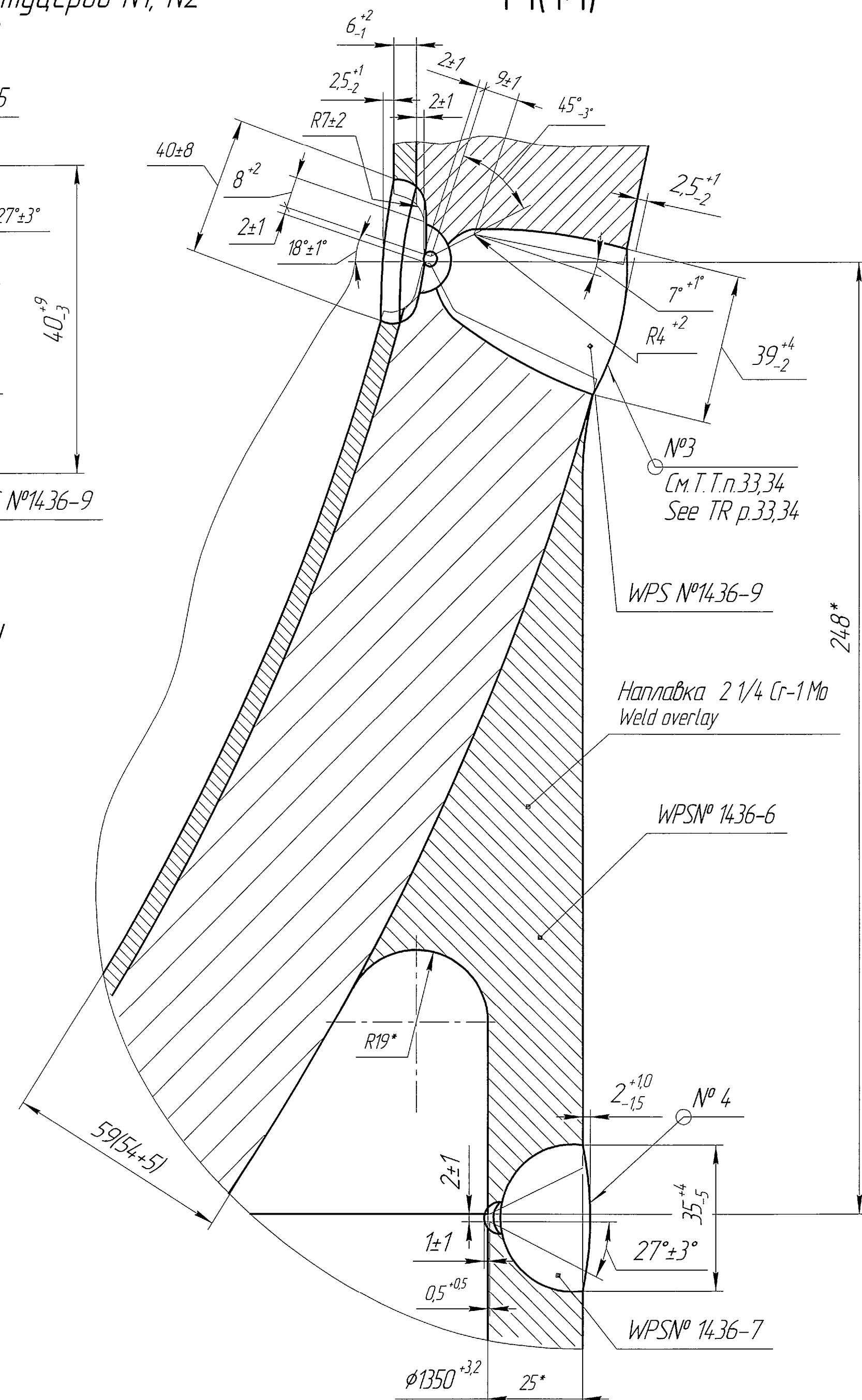

Q1(1:2)(1)

Приварка опорного кольца к корпусу
Welding of support ring to shell

